

PARTS

- A** front slats - (4) 1 x 6 x 48"
- B** short corner posts - (4) 2 x 2 x 22 3/8"
- C** long corner posts - (2) 2 x 2 x 24 3/8"
- D** side panel slats - (8) 1 x 6 x 23"
- E** front panel - upper cleat - (1) 2 x 2 x 43 1/2"
- F** front panel - lower cleat - (1) 2 x 2 x cut to fit
- G** side panel cleats - (4) 2 x 2 x 18 3/4"
- H** plywood top - (1) 5/8" x 23 1/4" x 46 1/2"
- I** plywood bottom - (1) 5/8" x cut to fit
- J** uprights - (2) 2 x 4 x 70" (see drawing)
- K** braces - (2) 2 x 4 x 14" (see drawing)
- L** plywood roof - (1) 5/8" x 24" x 54"
- M** roof trim - (2) 2 x 2 x 24"
- N** plywood sign - (1) 5/8" x 4" x 21"

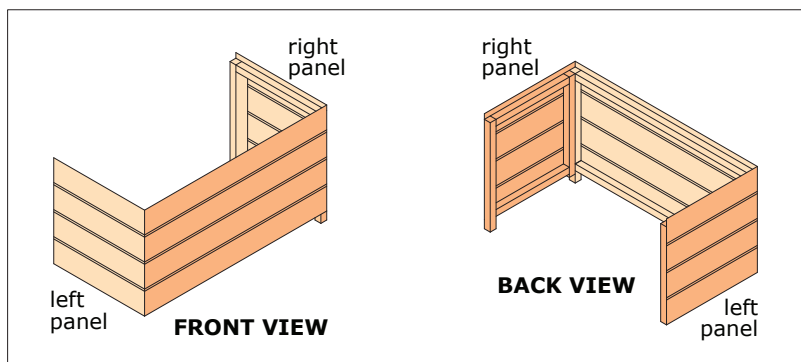

The left and right side panels are labelled based on the front view.

FRONT PANEL

Lay the front panel slats on a flat surface and space them 1/2" apart using spacers.

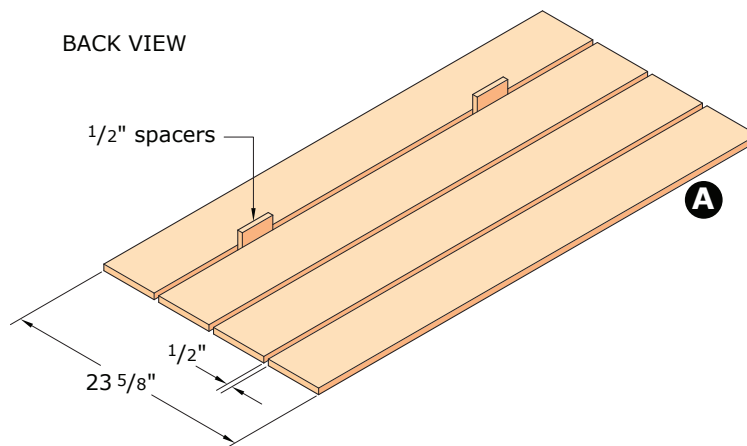

BACK VIEW

The "C" corner post extends 2" beyond the bottom edge of the bottom slat.

Position the posts 1 1/4" from the top edge of the top slat, and 3/4" in from both sides.

Glue, clamp and nail the posts to the slats.

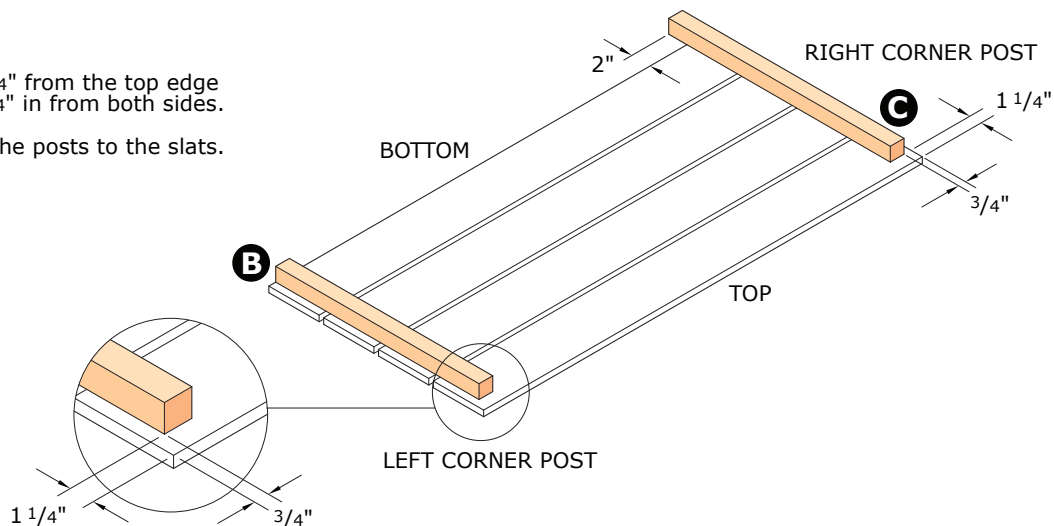

LEFT SIDE PANEL

Position both posts $1\frac{1}{4}$ " from the top edge of the top slat.

Glue, clamp and nail the posts to the slats.

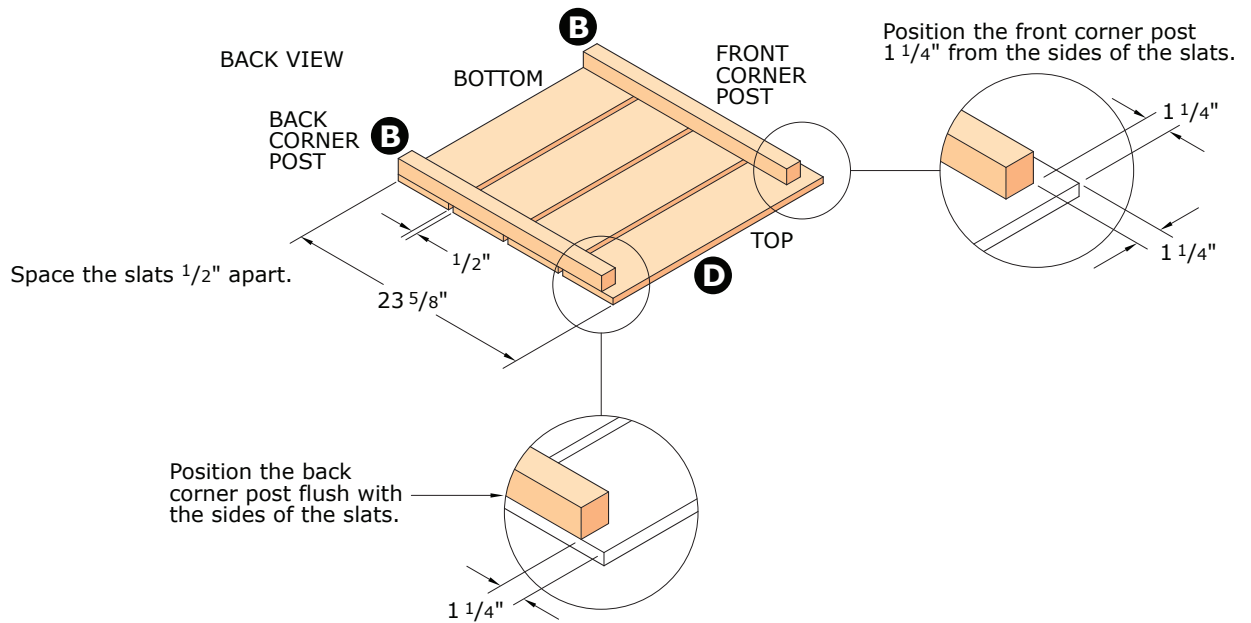

RIGHT SIDE PANEL

Position both posts $1\frac{1}{4}$ " from the top edge of the top slat.

Position the front corner post $1\frac{1}{4}$ " from the sides of the slats.

Glue, clamp and nail the posts to the slats.

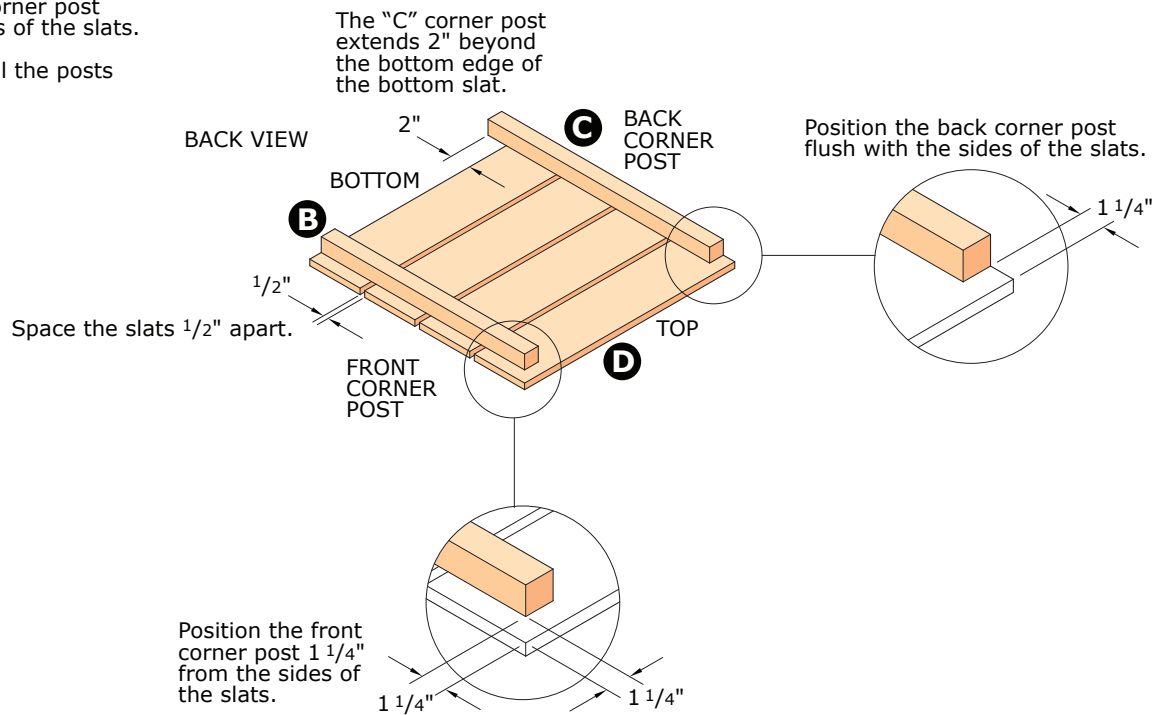

ASSEMBLE PANELS

Assemble the two side panels to the front panel with #8 x 2 1/2" exterior screws.

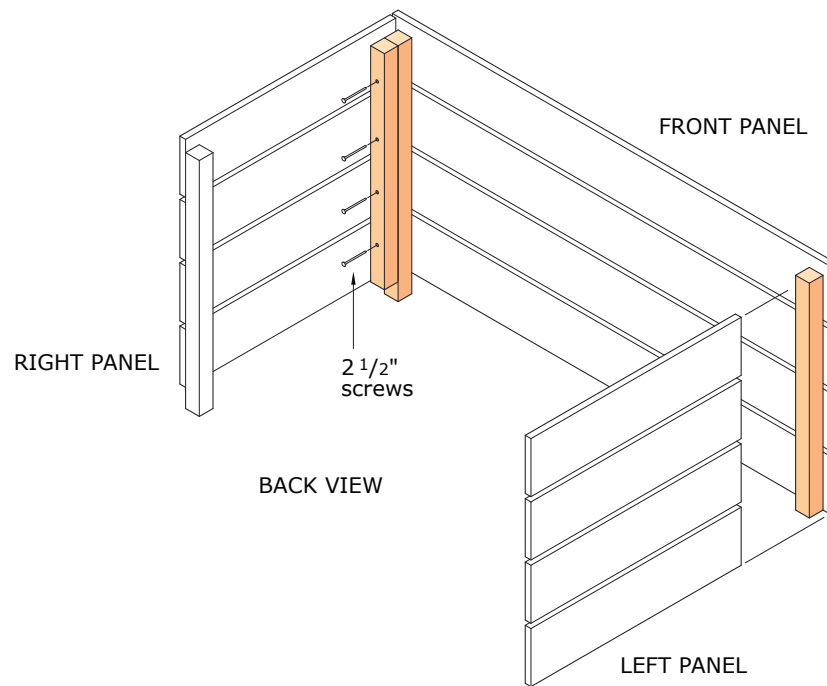

CLEATS

Glue, clamp and nail the cleats to the slats.

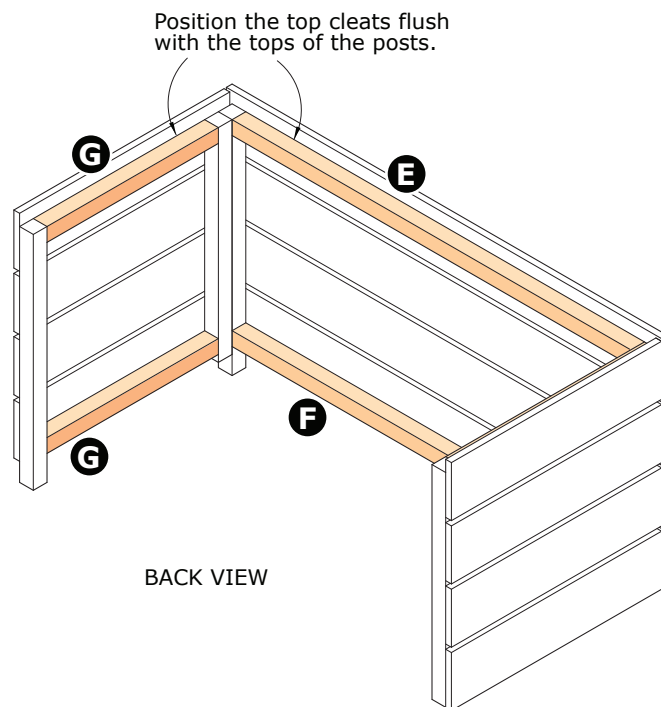

BACK VIEW OF RIGHT PANEL

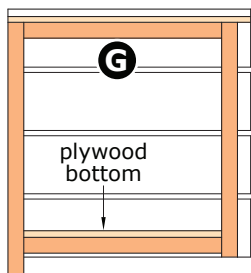

BACK VIEW OF FRONT PANEL

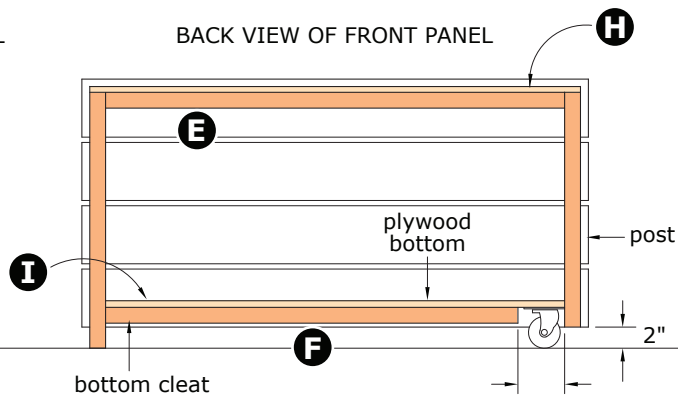

BACK VIEW OF LEFT PANEL

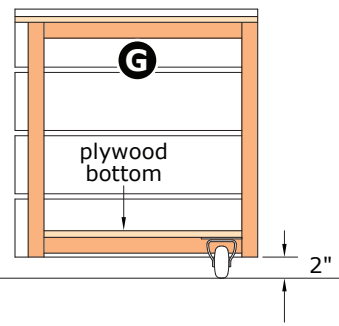

Leave enough space between the cleat and the post so that the castor can fit right up against the front panel slat.

Position the lower cleats so that when the castors are fastened to the bottom of the plywood, the castors will extend 2" below the bottom slats.

PLYWOOD PANELS

Fasten the top and bottom plywood panels to the cleats with #6 x 1 5/8" exterior screws.

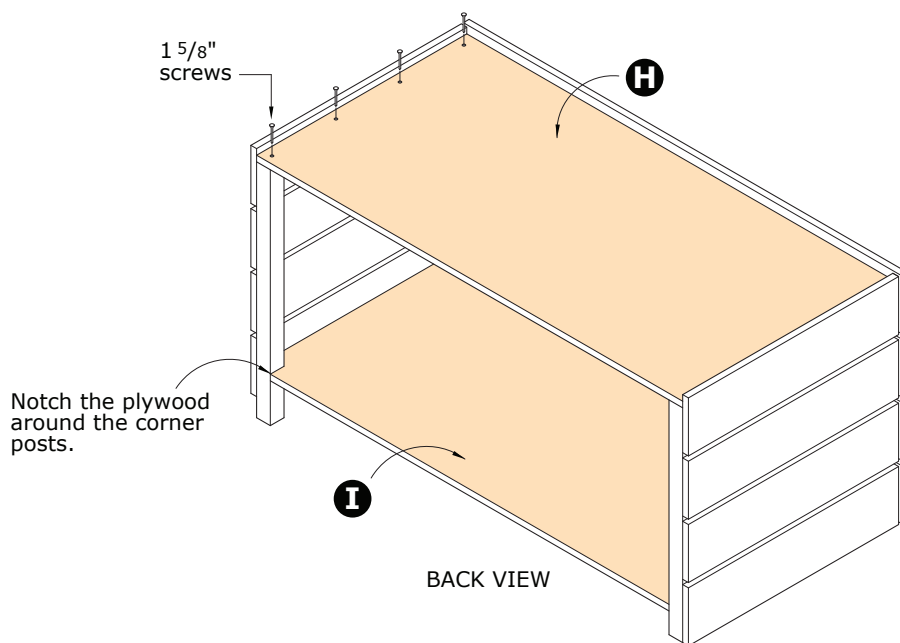

UPRIGHT ASSEMBLIES

Cut the uprights and the braces.

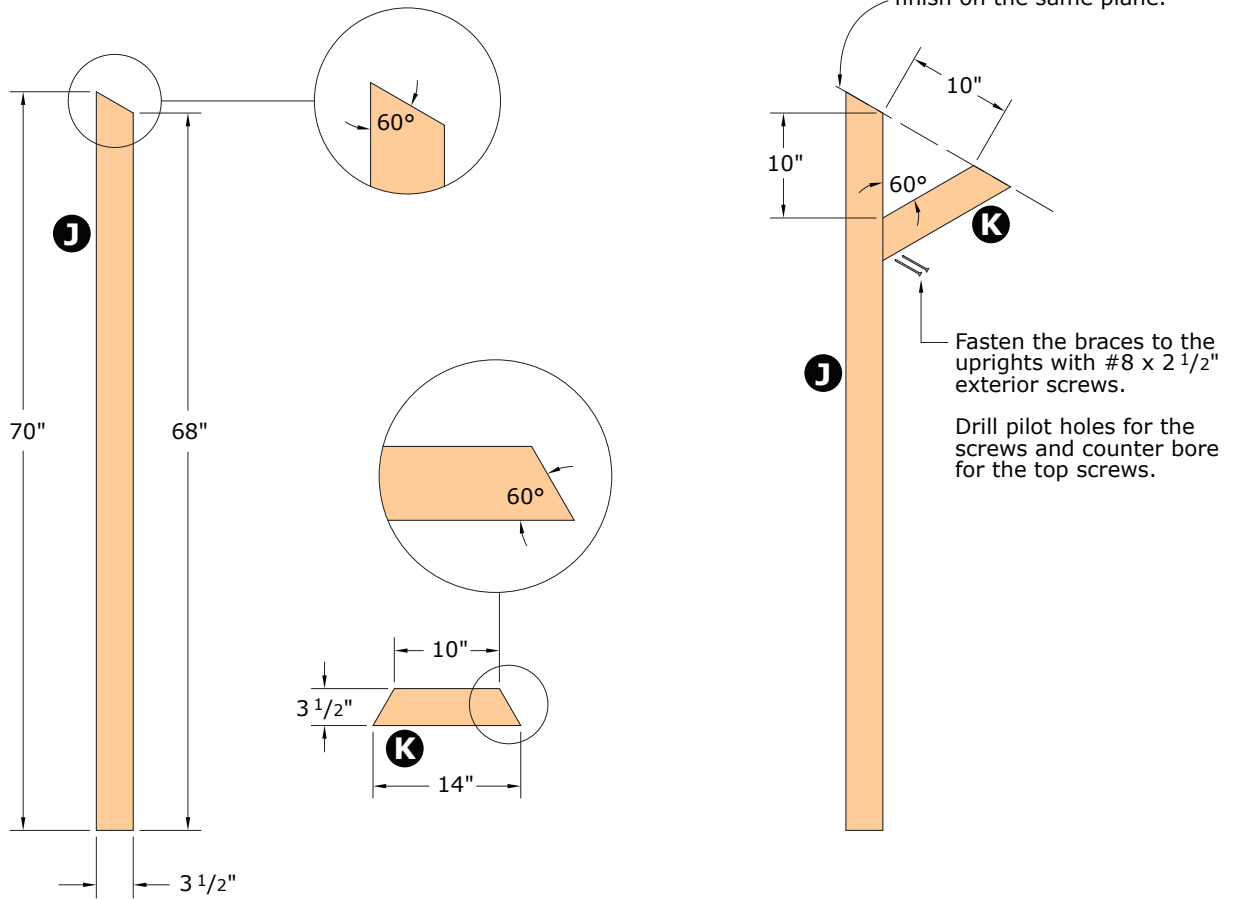

UPRIGHT ASSEMBLIES

Fasten the uprights to the base assembly.

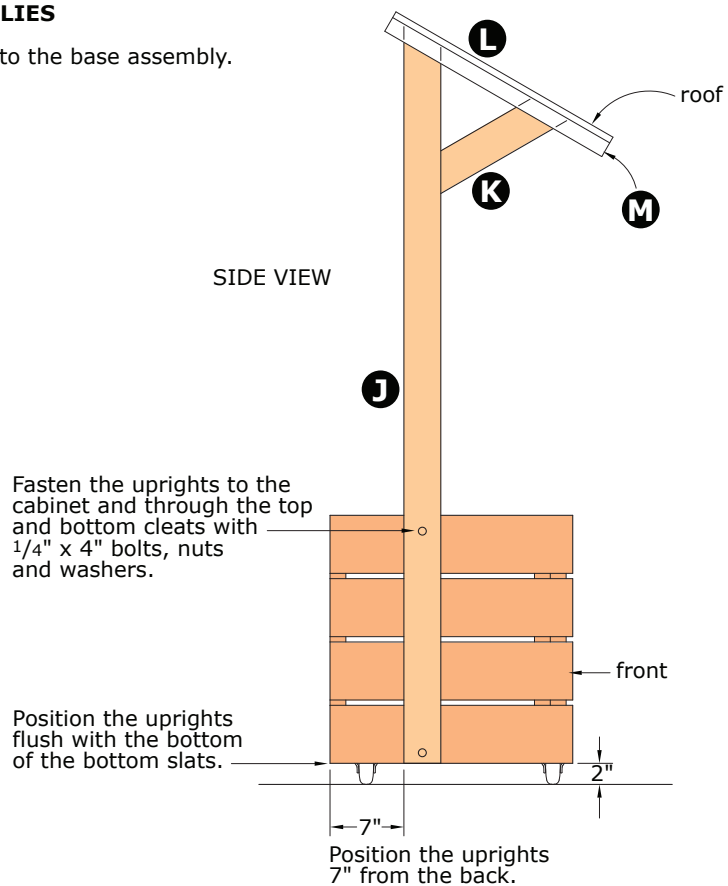

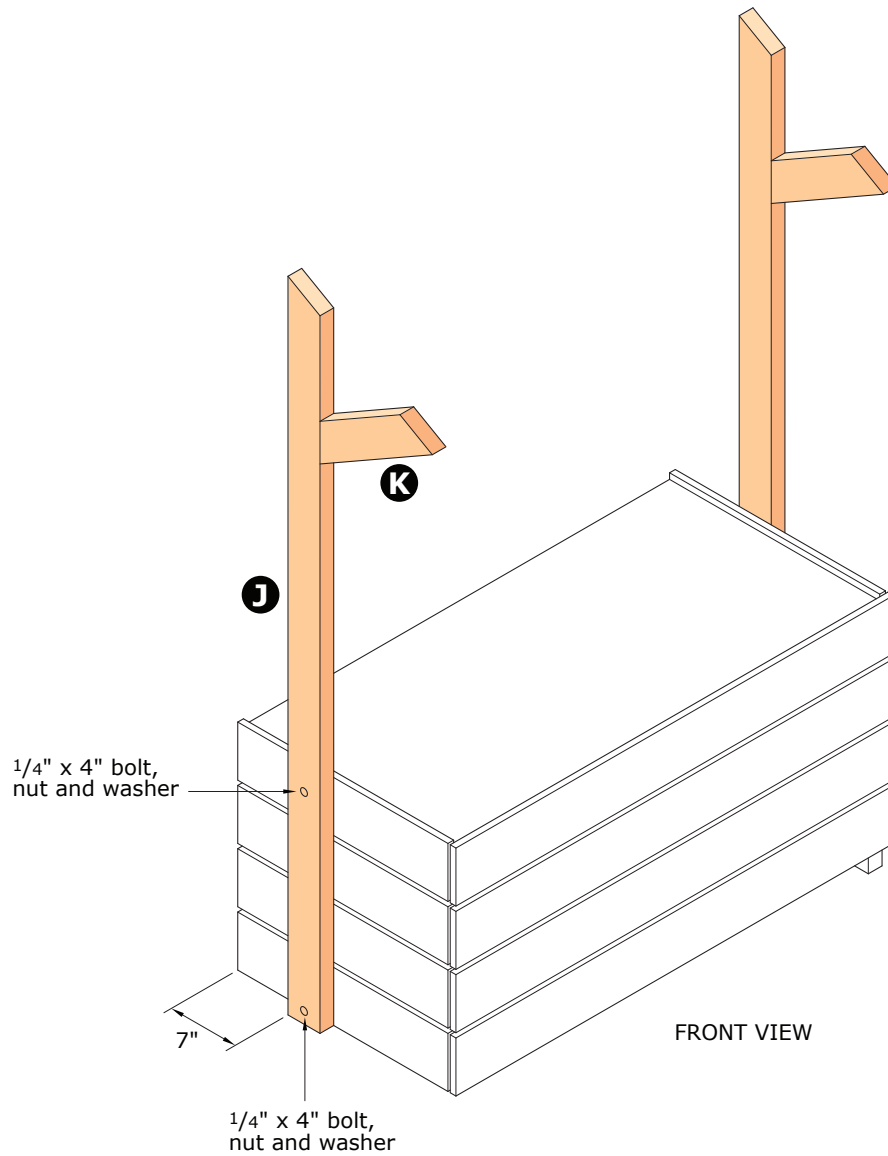

ROOF

Assemble the roof.

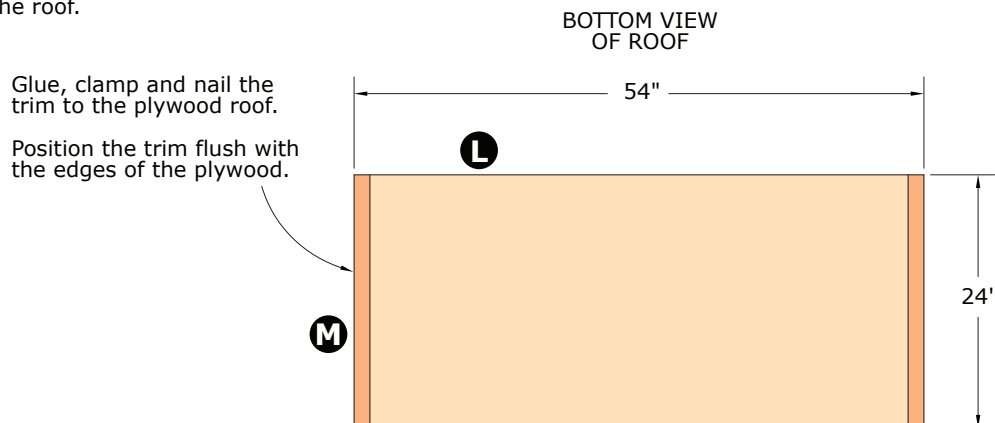

Staple three rows of shingles to the plywood roof.
Add a bead of glue under the front ends of each
row of shingles and clamp until dry.

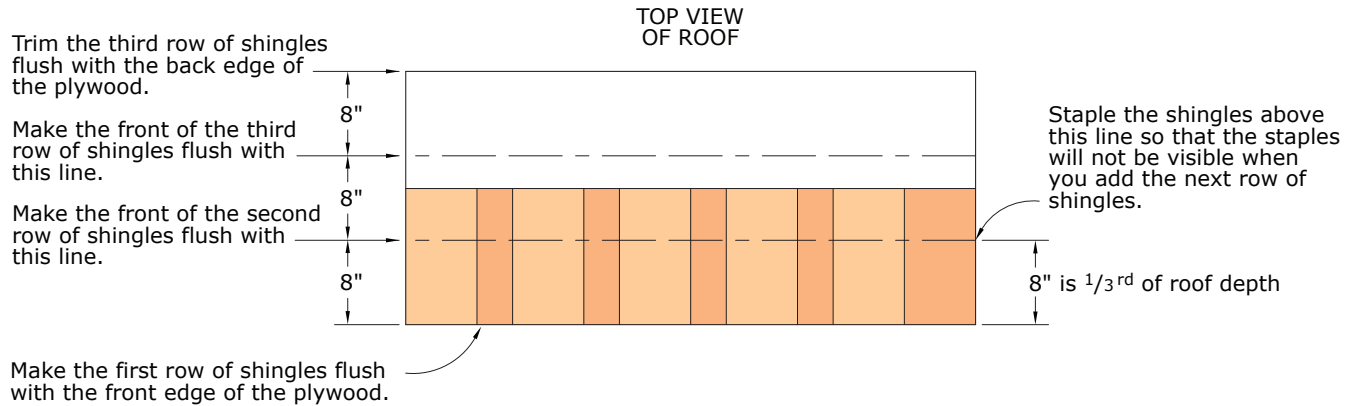

INSTALL ROOF

Centre the roof (from left to right) on the
uprights and position the back of the roof
1" from the backs of the uprights.

Fasten the roof trim to the uprights and the
braces with #8 x 2 1/2" exterior screws
through the roof trim from the inside.

Drill a clearance hole through the uprights
so that the wood won't split.

To hold the roof in place while you
are installing it - drive two screws
into the roof 1" from the top edge
to hook over the uprights.

